

## ORDERING INFORMATION

Description	Model Number	Flange Type
10" diameter MULTI-TRAP ; 1.5" inlet/exhaust ports. Requires 5 filter elements in stage 2 and 5 elements in stage 3 (elements <b>not</b> included).	355040	NW-40
Same as 355040 except with 2" ports.	355050	NW-50
Cooling option for 355040,355050,355063	355210	n/a
12" diameter MULTI-TRAP ; 3" inlet/exhaust ports. Requires 6 filter elements in stage 2 and 6 elements in stage 3 (elements <b>not</b> included).	355080	ISO-80
Same as 355080 except with 4" ports.	355100	ISO-100
Cooling option for 355080,355100,355082,355102	355212	N/A
Same as 355040, except straight-thru configuration. (inlet on bottom)	355041	NW-40
Same as 355050, except straight-thru configuration. (inlet on bottom)	355051	NW-50
Same as 355080, except straight-thru configuration. (inlet on bottom)	355081	ISO-80
Same as 355100, except straight-thru configuration. (inlet on bottom)	355101	ISO-100
Same as 355050, except ISO-63 flanges.	355063	ISO-63
12" diameter MULTI-TRAP ; 3" inlet/exhaust ports and cooled filter assembly. Requires 5 filter elements in stage 2 and 5 elements in stage 3 (elements <b>not</b> included).	355082	ISO-80
12" diameter MULTI-TRAP ; 3" inlet/exhaust ports and cooled filter assembly. Requires 5 filter elements in stage 2 and 5 elements in stage 3 (elements <b>not</b> included).	355102	ISO-100
Stacking modules for 10" diameter.	355020	
Stacking modules for 12" diameter.	355022	
16" diameter MULTI-TRAP ; 6" inlet/exhaust ports. Requires 8 filter elements in stage 2 and 8 elements in stage 3 (elements <b>not</b> included).	350160	ISO-160
MULTI-TRAP converted to hold one stage of 9.5" filter elements instead of 2 stages of 4.5" elements.	Add "S" to number	n/a

Also visit us on the web at:  
[www.massvac.com](http://www.massvac.com)

**CALL TO ORDER**  
**+44 (0)1327 362 844**

## Key Features

### Designed for chemical and pharmaceutical processes

- Large cooled surface area for condensing of solvents, acids, and water vapor
- All stainless steel construction withstands corrosive environments
- Modular design allows for numerous configurations and easy servicing
- Stacking modules available for increased capacity
- Optional drain port for solvent draining and reclamation
- Customizable absorption/neutralization stages for optimal efficiency
- Processes such as distillation, drying, degassing, central lab vacuum protection

MV MULTI-TRAP is a high efficiency vacuum pump inlet or exhaust trap designed specifically to condense, absorb, and neutralize process byproducts generated from vacuum applications in the chemical and pharmaceutical industries.

This compact low temperature, low pressure, stainless steel vacuum trap can be used to remove solvents, acids, particulate, and water vapor from the gas stream coming off reactors and dryers.

Offers up to four stages of customizable trapping, including a cooled baffle section, separate cooling option with drain, particle filtration, solvent vapor absorption, as well as acid neutralization. The modular design allows for easy service and add-on capacity.

The vessel will hold up to several gallons of condensed solvent, and can be retrofitted with float switch, waste reservoir and draining accessories.



Model 355102

Acts as a final protection device to be installed after the main vacuum pre- or post-condensers. The unit is used as a secondary condensing/absorption accumulation vessel to remove residual by-products from vacuum distillation and drying processes.

The unit can be installed in any location in the system to protect liquid ring, oil sealed, and dry vacuum pumps. May also be installed on the vacuum pump exhaust for solvent reclamation, to reduce load on the central scrubbers, and protect the environment.

## SPECIFICATIONS

- Construction: Stainless steel
- Seals: Buna N upper and lower seals
- Dimensions: Refer to drawings for specific models

## CALL TO ORDER

SiSTEM Technology Limited  
Suite 3 - Innovation Centre  
Silverstone Technology Park  
Towcester NN12 8GX  
United Kingdom  
+44 (0)1327 362 844  
sales@sistemtechnology.com  
www.sistemtechnology.com

**FILTER STAGES**

Model	Number of Filter Stages	Filter Size	Number of Filters Per Stages	Total Number of Filters
355040	2	4.5"	5	10
355050	2	4.5"	5	10
355080	2	4.5"	6	12
355100	2	4.5"	6	12
355041	2	4.5"	5	10
355051	2	4.5"	5	10
355081	2	4.5"	6	12
355101	2	4.5"	6	12
355063	2	4.5"	5	10
355082	2	4.5"	5	10
355102	2	4.5"	5	10
350160	2	4.5"	8	16
355040S	1	9.5"	5	5
355050S	1	9.5"	5	5
355080S	1	9.5"	6	6
355100S	1	9.5"	6	6
355041S	1	9.5"	5	5
355051S	1	9.5"	5	5
355081S	1	9.5"	6	6
355101S	1	9.5"	6	6
355063S	1	9.5"	5	5
355082S	1	9.5"	5	5
355102S	1	9.5"	5	5
350160S	1	9.5"	8	8

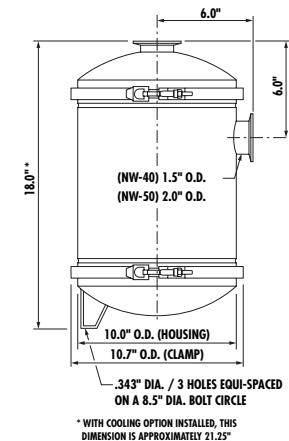

MODEL 355040 (NW-40)  
MODEL 355050 (NW-50)

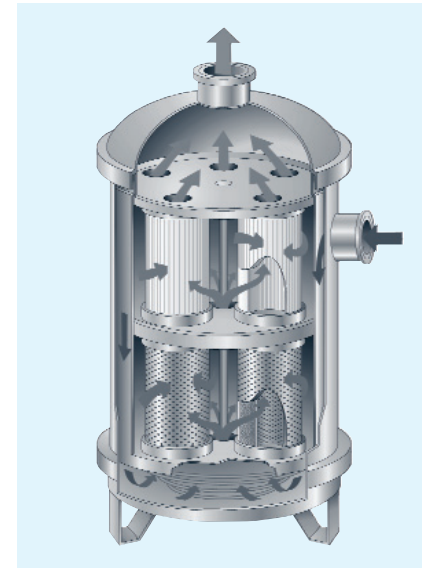

Cutaway view showing optional cooling accessory

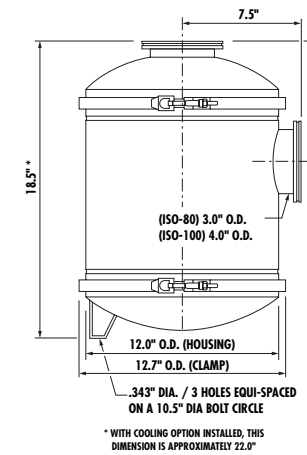

MODEL 355080 (ISO-80)  
MODEL 355100 (ISO-100)

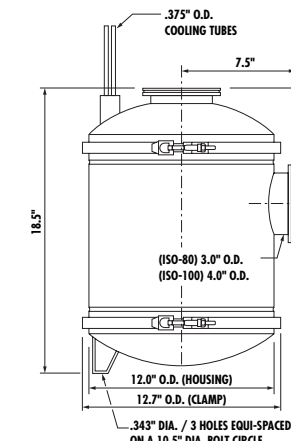

MODEL 355082 (ISO-80)  
MODEL 355102 (ISO-100)

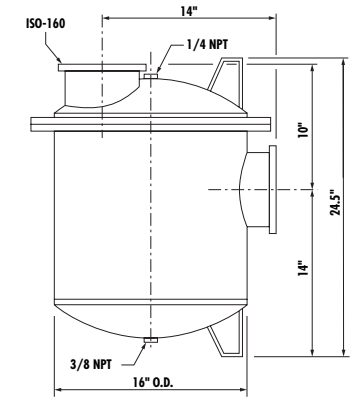

MODEL 350160 (ISO-160)

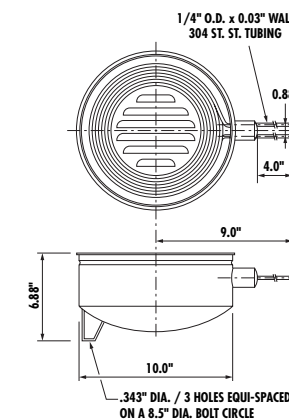

COOLING COIL ACCESSORY  
MODEL 355210



12" MULTI-TRAP®  
with cooling accessory

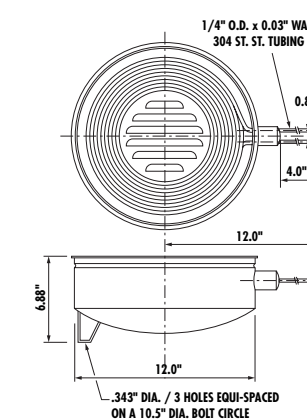

COOLING COIL ACCESSORY  
MODEL 355212

**Filter Media**

	Part Number 4.5" Size	Part Number 9.5" Size
Copper gauze	300905	300900
Stainless	300915	300910
Molecular sieve	300925	300920
Sodasorb®	300935	300930
Activated charcoal	300945	300940
PolyPro 2m	400925	400920
PolyPro 5m	400935	400930
PolyPro 20m	400945	400940